

1. Tile ROCKFON, edge B
2. Adhesive
3. Perimeter trim MDF/Wood

A-A

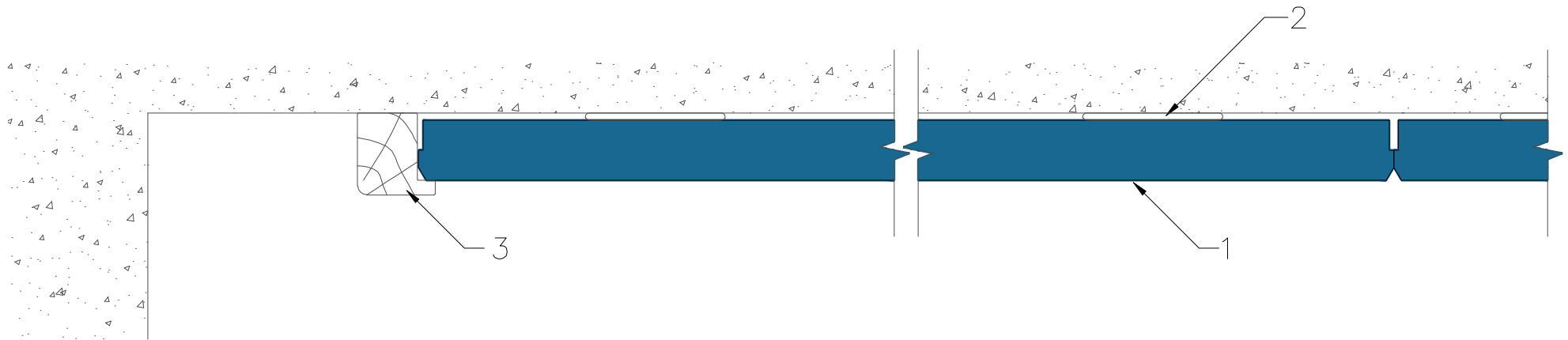

All screws and other fastenings shown are indicative and illustrative only.
 Specific fasteners should be chosen dependent on substrates and materials being used.

Information: We kindly draw your attention to the fact that the above drawings should be considered as guidelines and therefore are without responsibility on the part of Rockfon.	Date: 24.02.2014		Drawing Type:	
	Drawing No.: 9.1.3.Rockfon B glue		Drawn by:	Scale: 1:2
	Contact Information:			

