

1. Tile ROCKFON, edge A
2. Mainrunner T24 C/H38 3600 white
3. Cross Tee T24 C38 1200 white
4. Frieze hanger
5. Adjustable hanger
6. Wall Angle 24/24 3050 white
7. S-line 200 profil
8. Frieze connector

A-A

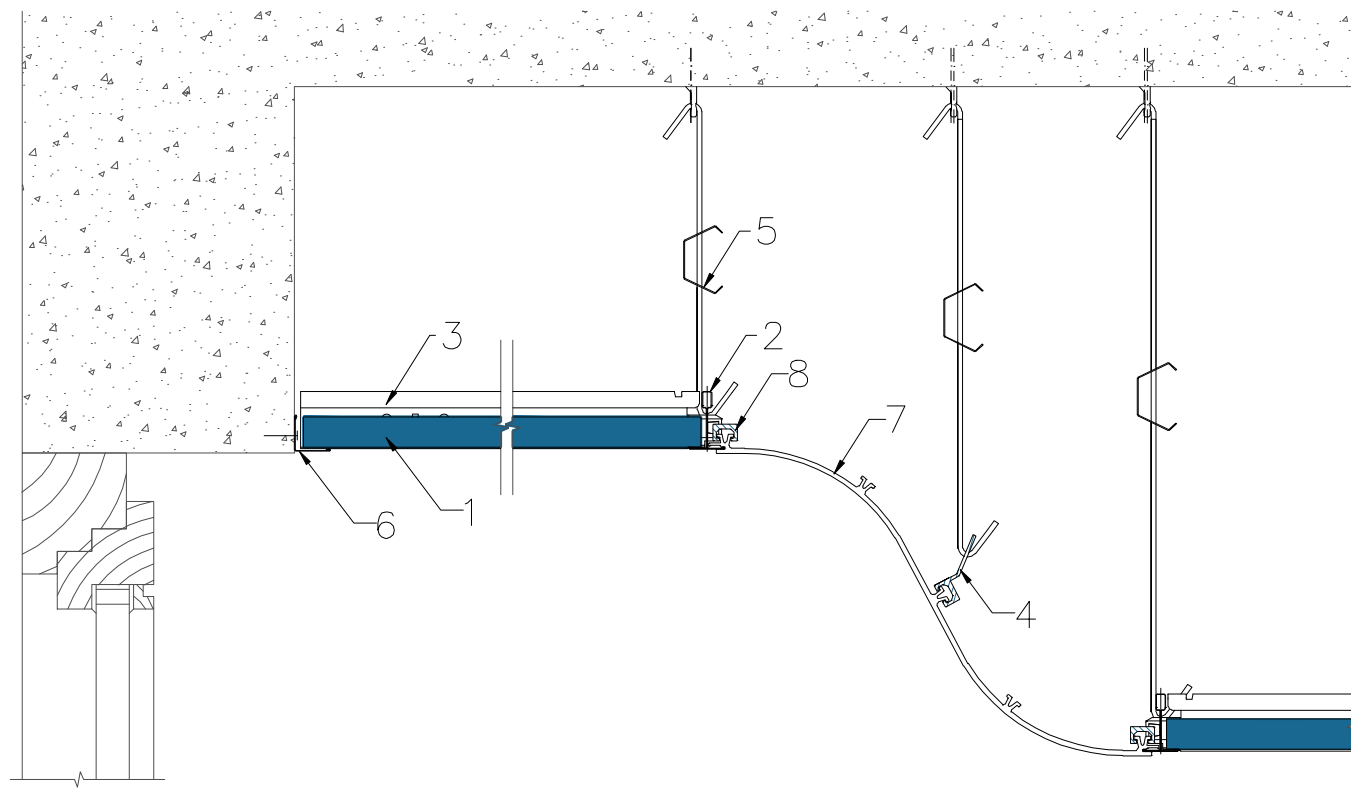

B-B

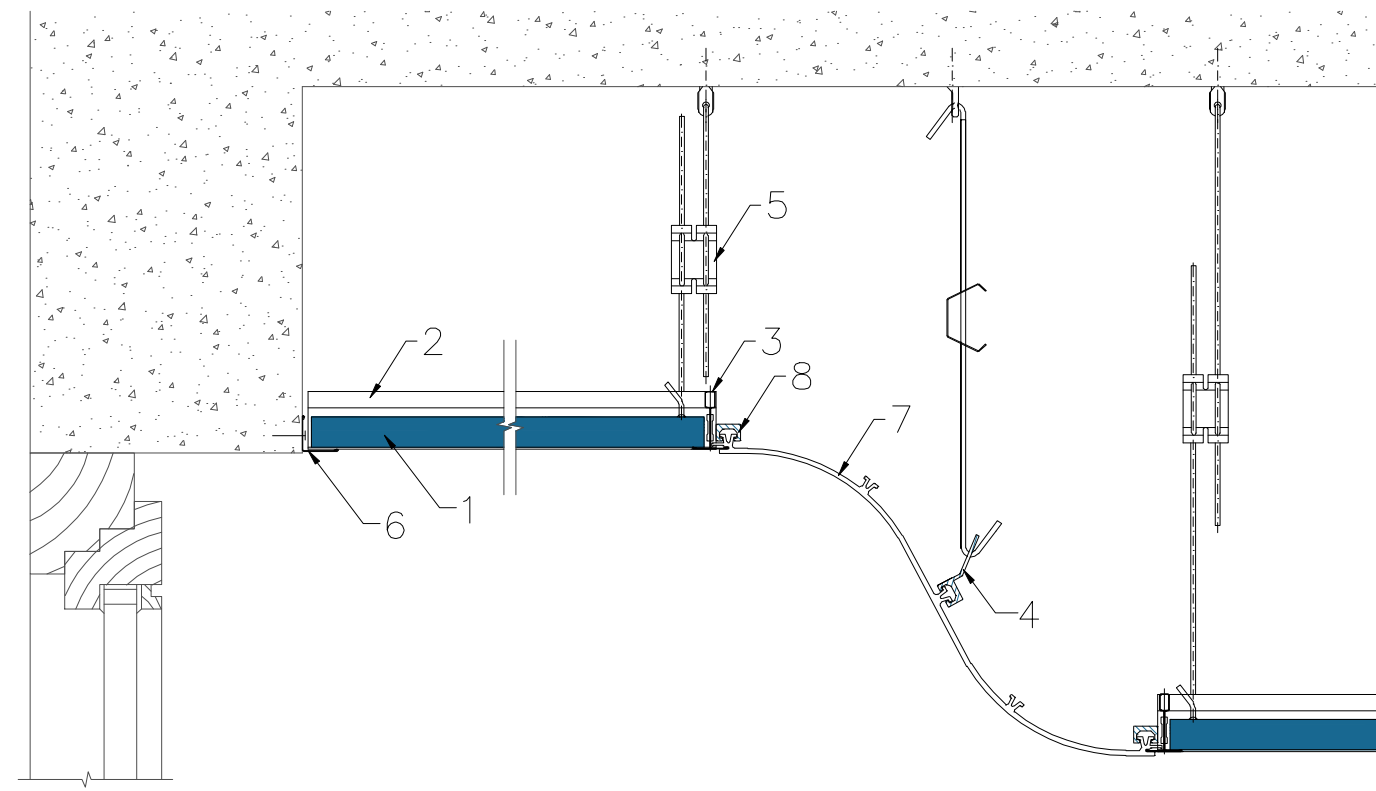

All screws and other fastenings shown are indicative and illustrative only.
Specific fasteners should be chosen dependent on substrates and materials being used.

Information:
Light from windows – S-line 200 aluminium profil

Date:
11.04.2014

Drawing Type:

Drawing No.:
3.1.1.Light-incidence

Drawn by:

Scale:
1:5

Contact Information:

We kindly draw your attention to the fact that the above drawings should be considered as guidelines and therefore are without responsibility on the part of Rockfon.

Rockfon[®]