

Full scale drawing is available in model space

1.	Tile VertiQ A HAT 2700x1200 [mm]
2.	Perimeter trim 3050 mm long 40 mm J channel
3.	HAT channel 40 mm high, 0,5 mm thick, 12,5/25,0/12,5 [mm], 2672 mm (cut to size from 2700 mm)
4.	Supporting bracket 15x35x50 mm

A1-A1

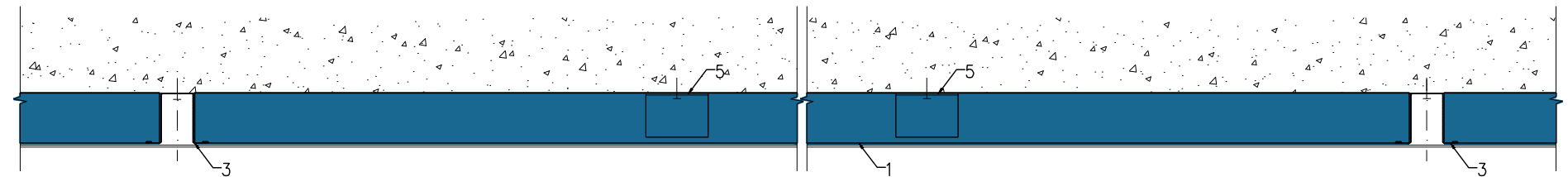

A2-A2

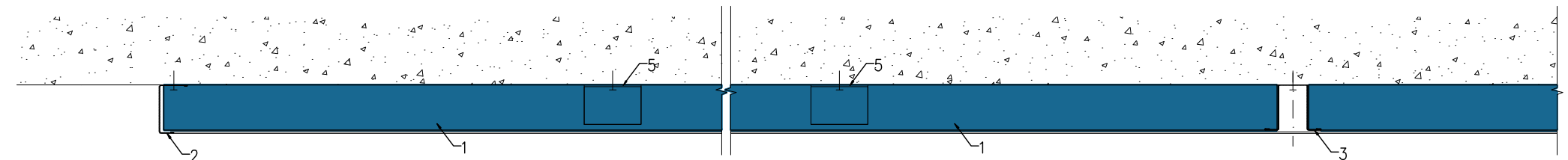

All screws and other fastenings shown are indicative and illustrative only. Specific fasteners should be chosen dependent on substrates and materials being used.

Information:

Date:

12.01.2016

Drawing Type:

Drawing No.:

30.2.2. VertiQ HAT

Drawn by:

Scale:

1:5

Contact Information:

Rockfon[®]

We kindly draw your attention to the fact that the above drawings should be considered as guidelines and therefore are without responsibility on the part of Rockfon.