

Rockfon Concealed Acoustical Ceiling Systems (CDX and SCD)

System overview

Description

Rockfon CDX edge tile is a fully concealed system that provides an elegant, unbroken ceiling expression. Rockfon SCD edge tile is a semi-concealed system that provides a more monolithic looking ceiling than traditional reveal tiles leaving a 1/4" reveal throughout the ceiling. Both systems provide 100% downward accessibility (unless penetrations exist).

Rockfon CDX and SCD edges are available in White and Rockfon Color-All options. For certain projects custom tiles are available to special order. When installing custom tiles 48" or larger they must be handled by two people.

Technical data

Weight and depth

Rockfon CDX and SCD tiles can be installed with a suspension minimum depth of 2.5".

System load-bearing capacity

See appropriate Chicago Metallic Data Sheet

Installation conditions

Temperature and humidity

Rockfon ceiling tiles are non-hygroscopic and dimensionally stable, even at humidity levels of up to 100% RH. Since the humidity inside a building has no influence on Rockfon ceiling tiles, the ceiling can be installed at all temperatures ranging from 0°C to 40°C.

This also means that no acclimatisation is necessary and that it is possible to install Rockfon ceiling tiles during the very early stage of the build (when windows are not fully sealed) without risk of tile deflection.

Planning

CDX and SCD tiles are a finished ceiling

Installation

The CDX and SCD tiles provide full demountability of the installed tiles.

Handling

It is recommended to use clean gloves with a non-marking rubber/latex coating or Polyethylene gloves when handling Rockfon tiles to avoid contamination. The tiles are easy to cut with a sharp knife.



Rockfon Concealed Acoustical Ceiling Systems (CDX and SCD)

1. Suspension System installation

24" x 24" and 48" x 24" CDX and SCD edge tiles

For 24" x 24" or 24" x 48" CDX or SCD tiles suspended grid should be carried out in accordance with the general Chicago Metallic 1200 15/16" Suspension System. **Both CDX and SCD systems require a completely square suspension system following all ASTM C636 practices. Correct Suspension Installation is mandatory – contact Technical Services at 800-323-7164 for further installation instructions.**

Distance overview		
A	Max. distance to the first main runner	48"
B	Distance between main runners	48"
C	Max. distance to the first 1200 cross tee	24"
D	Distance between 1200 cross tees	24"
E	Distance between 600 cross tees	48"

- - Perimeter Trim
- - Hangers
- - Main Runners
- - - - - 48" Cross Tees
- - - - - 24" Cross Tees
- - Central Tiles
24x24 or 48x24
- - Perimeter Tiles

24" x 24" tiles

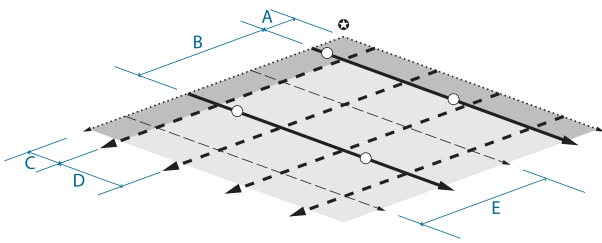

48" x 24" tiles

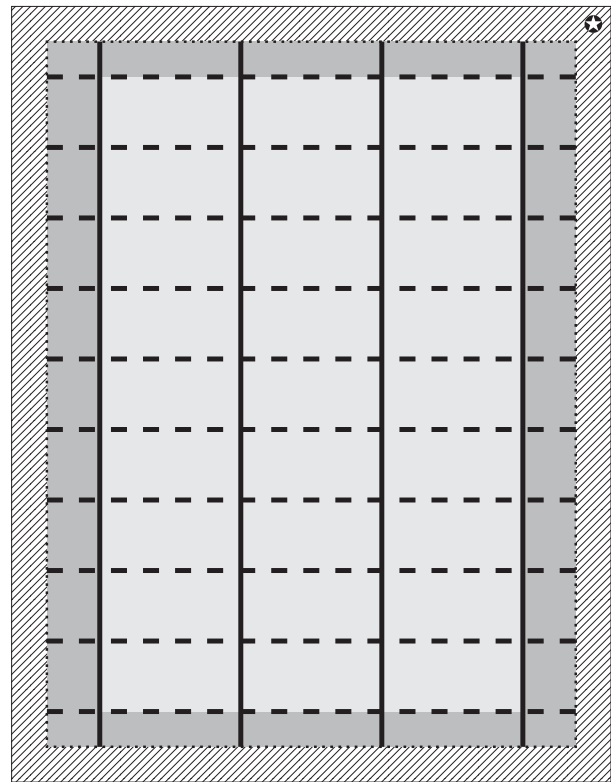
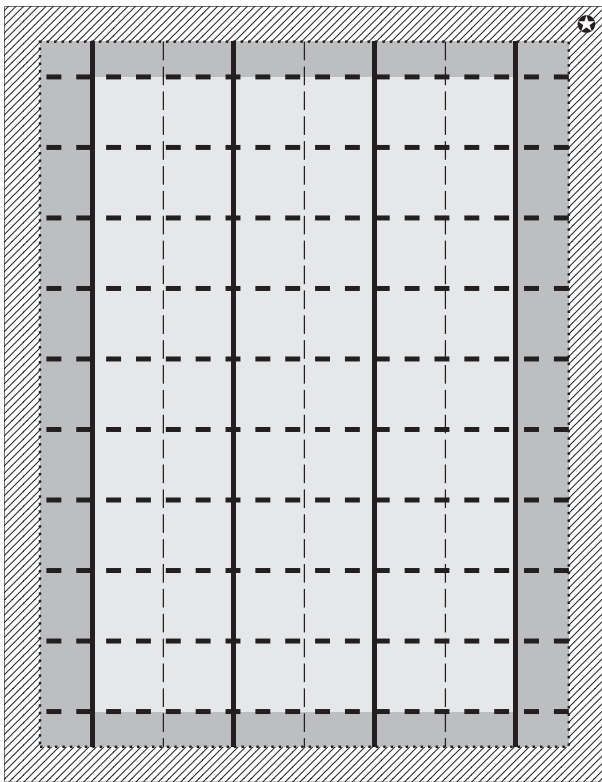
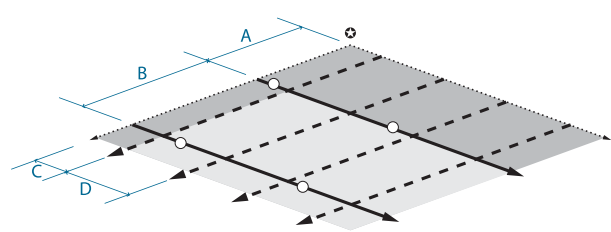

Rockfon Concealed Acoustical Ceiling Systems (CDX and SCD)

2. Tile Edge Orientation

Rockfon concealed tiles have a patented construction that makes them like no other tile in the industry! For system acceptance every tile installed must be bearing on at least two edges during installation.

CDX Fully Concealed

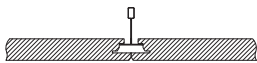

X1: Supporting edge.

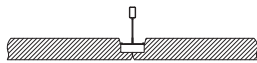

X2: Non-supporting edge.

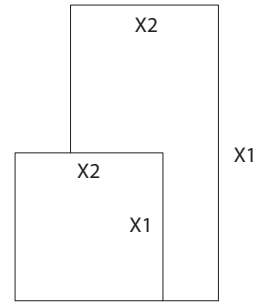

SCD Semi-concealed

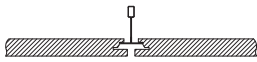

M1: Supporting edge.

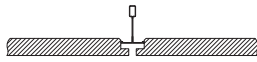

M2: Non-supporting edge.

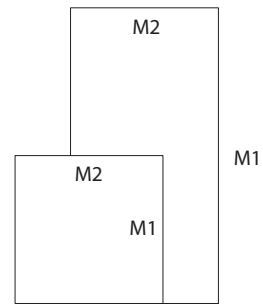

Rockfon Concealed Acoustical Ceiling Systems (CDX and SCD)

3. Tile Installation

Follow the procedures below to install Rockfon concealed tiles.

Rockfon CDX

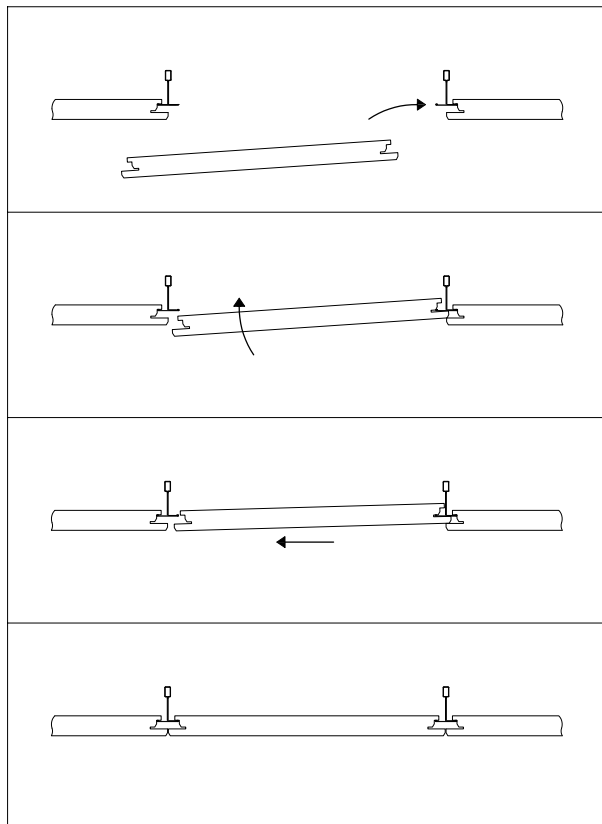

Rockfon SCD

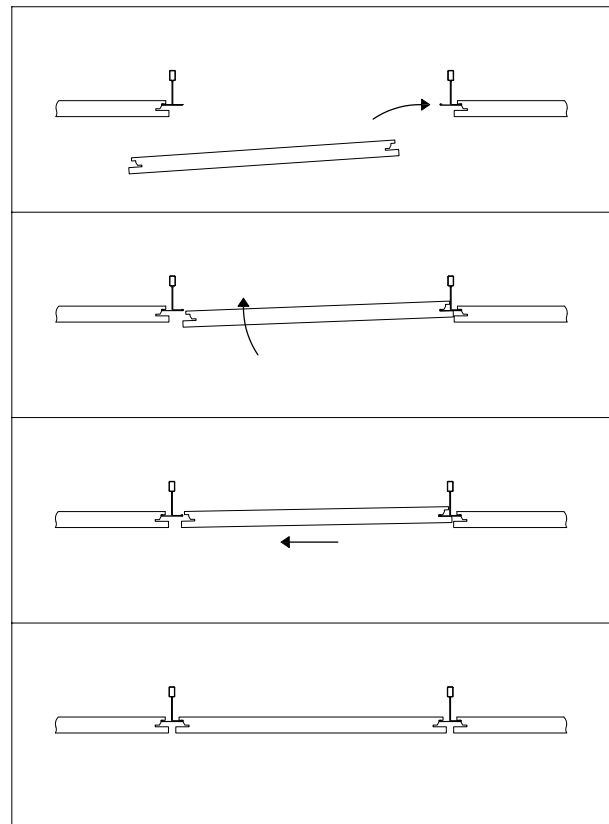

Rockfon Concealed Acoustical Ceiling Systems (CDX and SCD)

4. Perimeter Detail Options

When using Rockfon Concealed and Semi-concealed tiles there are a few different ways to finish the perimeter to give the best overall ceiling appearance.

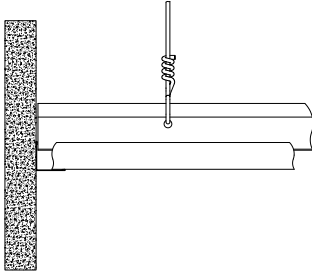

4.1 Standard Suspension and Wall angle spaced correctly for tile drop.

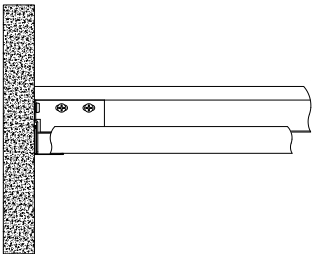

4.2 Rockfon CDX/SCD Perimeter Clip with Chicago Metallic 1420 wall angle. This clip sits perfectly on our most common wall angle and provides the perfect spacing and attachment for suspension systems at the perfect distance for CDX or SCD tiles to be flush cut and placed on the wall angle.

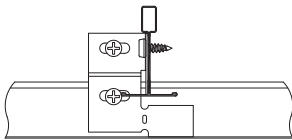

4.3 Screw pattern and clip appearance for Rockfon CDX Tiles

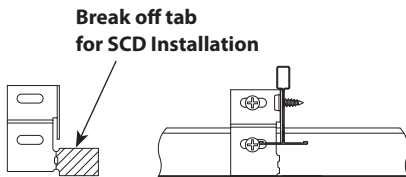

4.4 Screw pattern and clip design for Rockfon SCD Tiles

Rockfon Concealed Acoustical Ceiling Systems (CDX and SCD)

5. Service integration

The preferred lights for CDX and SCD lights are pendent lights or flange style light fixtures that can be independently supported from the above structure. If lights integrate within a tile the tile will not be an accessible tile and careful planning should be taken. Contact Rockfon Technical Service at 800-323-7164 for support in light fixture integrations.

A variety of service installations and lights can be easily integrated into this system.

Service installations should not be supported on the ceiling tile alone. Service loads should always be adequately spread on the back of the tile or transferred to the grid system using appropriate support arms or yokes. Alternatively, the service should be independently installed.

Integrated service installations may require additional support, depending on the unit weight, tile module size and the object's position in the grid system. Rockfon Technical Support can always be contacted for advice.

The yoke/patress should be the same length as the back of the Rockfon tile measured in the support direction and be minimum 3/4" x 6" wider than the hole required for the service installation. This applies to integrated service installations with diameters up to 13.5".

Tile size 24" x 24" x 5/8" and 48" x 24" x 5/8"

Diameters of more than 13.5" – the yoke should fill the entire back of the Rockfon tile.

Total weight of tile, patress and service item should not exceed 13.2 lbs.

Tiles larger than 30" x 30"

The service item should be independently supported or additional hangers should be placed on the grid components around the service item.

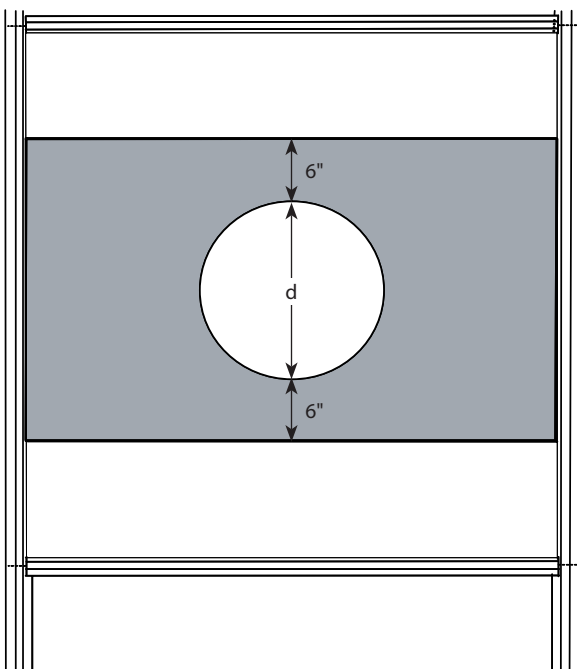

Supporting direction

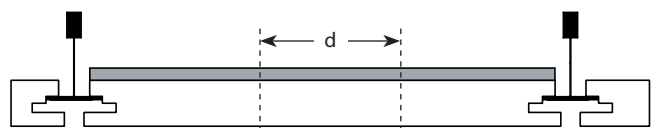

Non-supporting direction

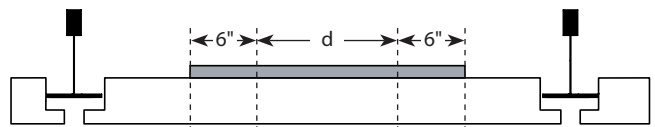

Rockfon Concealed Acoustical Ceiling Systems (CDX and SCD)

6. Trim Kits for Light Fixtures

Rockfon CDX and Rockfon SCD tiles achieve the desired look when mechanical services are chosen to complement the high end look of Rockfon concealed ceiling tiles. When a lay in light fixture must be utilized Rockfon supplies a light trim kit for CDX and SCD.

Installation is easy and the open edges of the tiles are closed off giving an acceptable look. Trims are available in 24" and 48" pre mitered lengths. For custom lengths contact Technical Service.

